

LANE & SHARED RIDE APP RESTRICTIONS

Departures Level - Terminal 5.5

Sunday, September 8 through Thursday, November 14, 2019



ACTIVITY:

The Terminal Cores and APM Interface project will restrict both drop off lanes at Terminal 5.5 (area between Terminal 5 and Terminal 6) Sunday, September 8 through Thursday, November 14 to facilitate the demolition of the Departures Level canopy at this area.

Ride App Pickup "E" will be closed Monday, September 9 and Tuesday, September 10, nightly from 11PM to 5AM, to allow for setup of the pedestrian detour.

IMPACTS CLOSED

- Both drop off lanes between Terminal 5 and Terminal 6 (Departures Level)
 - Passenger drop off lanes will be maintained and available before and after the restricted lanes
- Ride App Pickup "E": Monday, September 9 and Tuesday, September 10 from 11PM to 5AM
 - Signage will be posted to guide pedestrians to next available pickup spot

OPEN

- Traffic and passenger drop off will be maintained at all times
- Nearby Ride App Pickup "D" and "F" will be available for passenger use

PEDESTRIAN DETOUR

- Daytime 6AM to 10PM: Outside detour via outermost drop off lane or inside detour via terminal
- Nighttime 10PM to 6AM: Inside detour via terminal only

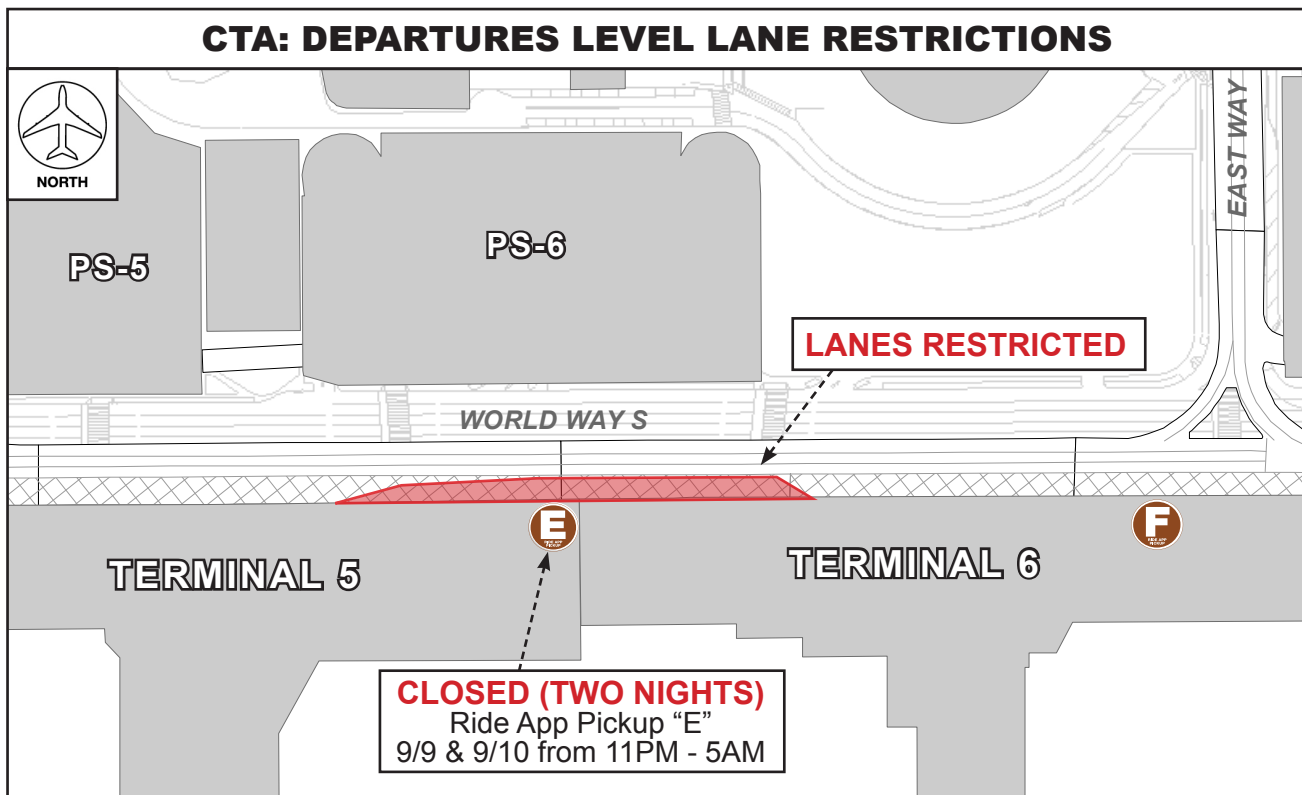

LAX Construction Hotline: 310-649-5292 | @FlyLAXAirport | LAInternationalAirport
 LAXConstructionHotline@LAWA.org